

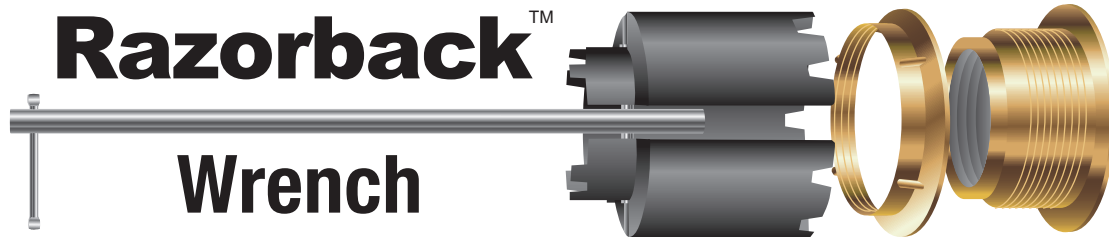

Razorback™ Wrench

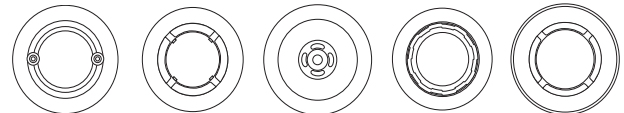

Versatile wrench fits popular basket strainers and shower drains!

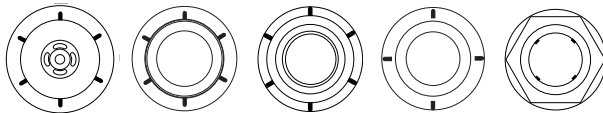

Remove basket strainers & shower drains from the top or bottom with just one hand!

The Razorback's unique design allows for one-handed installation of drains from the top or bottom.

Install and remove drains from the top.

Handle pivots 180° for narrow sinks.

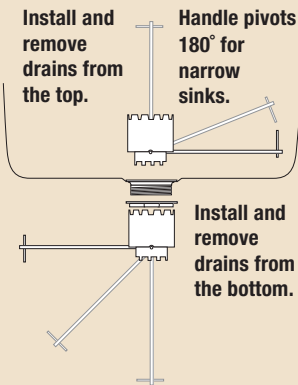

Install and remove drains from the bottom.

Mill-Rose designed this indispensable wrench to accommodate all popular basket strainers and shower drains. The Razorback Wrench addresses these common problems:

- Many fiberglass shower bases have wood or material "glassed in" to provide support. This material often extends past the drain, preventing access to the ring nut with a conventional wrench. No problem for the Razorback Wrench!
- Showers installed on wood floors usually have 3" to 4" of space between the wood floor and the shower drain preventing access to the ring nut with a conventional wrench. No problem for the Razorback Wrench!
- Many shower installations place drains too close to support studs preventing access to the ring nut with a conventional wrench. No problem for the Razorback Wrench!
- The Razorback Wrench can also be used on basket strainers. Its unique design simplifies installation and removal in crowded working areas - even when the sink is installed in a cabinet.

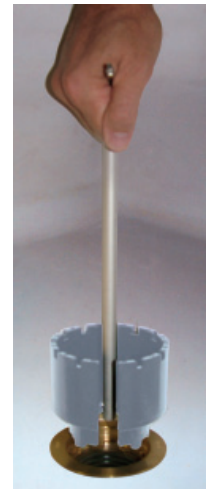

Handle pivots 180° for narrow sinks and other crowded working areas.



Attractive point-of-sale packaging promotes use of the Razorback drain wrench.

Cat. #	Description	Std. Pk.	Weight
73055	Razorback Wrench - display packaged	6	5.0 lbs.



Photographs of tool are gray to show detail of tool in use. Actual tool color is black.

7310 Corporate Blvd., Mentor, OH 44060
To order call toll-free: 1-800-321-3598 or Fax (440) 255-1072
Visit our web site at www.CleanFit.com • E-mail: info@CleanFit.com